

EAST END GREEN - CONSERVATION AREA

3.1.2 "A weatherboard range was added " This was the dairy.

3.1.4 A second well head exists in the western garden of White Cottage.

3.2 The farm managers cottage, the old dairy, and 3 barn residential units, plus the farmhouse , bring the total homes to 11.

The local pub was at Pipers End - 'The Black House' / 'The Red House' , since demolished for an architectural award winning replacement dwelling. This was ,up to post-war the milk station for East End Green Farm. Land girl Dorothy Biargini delivered the churns by pony and trap.

3.3 72 -34 = more like 38 metres,

3.7 19th Century ...and 3.7 20th Century ??? Nb. prefer : earned their living.....

Nb. (and 5.2)There are 3 rental flats and 3 residential units at the Farm.

Figure 1. This wonderful map, especially in colour, is far too small to read and its local importance demands to be a full page colour plate !

Page 28 Generally writing far too small to read.

Cat 1 non-listed farm buildings are covered by the farmhouse lising - as curtilege listed buildings.The barn, being listed, should be cerise , not orange ?

White Cottage stables inaccurate, The Cottage earlier garage building inaccurate.

There are no trees west of The Cottage on the triangle.

5.2 EEG is atypical - name another Hertfordshire hamlet without a metalled roadway crossing the green ?

It is even too small for a post box or gas supply !

Keepers Cottage - two storey plus attic. No attic casement to porch. Converted to single dwelling and extension added in

1970's

The Cottage - 'TeaS with Hovis' , a popular venue for cyclists.
.....been approved....

(The caravan occupants added greatly to the colourful diversity of the EEG population, and are worth recording - see planning history)

White Cottage - The current stabling and matching double-pile rear extension are late 20th C additions.

P36 - Photos too similar -swap second with photo of grain store on staddle stones or listed barn interior.

5.9 UnkeMpt.

3 other areas within the village... what is this ?

5.12 Southern views towards the valley are already important glimpsed from the RUPP junction with FP 3A. Currently obscured by now obsolete gravelling 'amenity bunds' they are now under threat of fresh further large scale unapproved Green Belt land raising . Think on..... I think it perverse to include the small mown grass area but then exclude the overgrown pond area east of The Poplars from the Conservation Area .

Clearance here would reinstate dramatic long views southwards from this public walkway viewpoint and enormously add to the overall experience and historic scope and setting of the Green.

P40 Do you really mean URBAN design ?

5.15 strongly disagree - see above. Historically important integral part of the Parish land.

7 , 2/,3/ Thank God this is still a WORKING Farm, despite previous asset stripping owners. Stock buildings , gates and fences need to be fit for purpose /utilitarian, and not generally thatched or wany chestnut.

8.1 (a) and Page 48 Other Actions : Improve the setting of the Conservation Area at the shallow winter pond scrubland to open up this area But then Dedesignate it Makes no sense ! Re draw CA boundary around this historic area (site of original farmstead)

17/04/2018

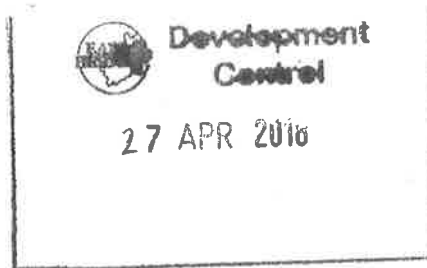

East End Green , Hertford , SG14

Mr M. Brown, Conservation Officer
Planning Department
East Herts District Council
Pegs Lane, Hertford SG13 8EQ

23rd April 2018

Dear Mr Brown,

East End Green Conservation Area - Draft Appraisal

Thank you for preparing this comprehensive and worthwhile document, and for introducing it to the residents last week.

I wish to object to the proposal to reduce the area of the Conservation Area at the eastern end of the Green , where the Parish Council ownership deed , copy attached, indicates a wide swathe extension of the formal Green, from the residential boundary of 'The Poplars' across to the junction of the RUPP with FP 3A.

Historically this was the site of the farmstead that predated the present East End Green Farm, and indicated on the Griffin 1732 map, but long since destroyed. The area now comprises two shallow ponds but is completely inaccessible and clogged with fallen and dead trees which obscure the remains of the veteran hedgerow which delineates the village Green southern boundary.

From 1975 I recall this as an open wetland wildlife area , very much part of the Green, and from which there were long open southward views across the valley to the far side of the River Lea. My neighbour at 'The Poplars' confirms this open view still existed until the late 1990's, since when there has been no maintenance, excepting to regularly mow an

isolated patch of grass next to her home, that bears no relevance to the extent and actual boundary of the formal green, and thereby resulting in the current appearance of dereliction to this part of the Conservation Area within the public domain, and where footpath walkers first reach sight of the green.

Your Section 8.15. Schedule of Enhancement Proposals, under Other Actions, does indeed propose opening up this area, which would reinstate one of the only two views southwards out from the Green, the other being from FP1, west of 'The Cottage', and, until recent vandallistic landraising new higher contours with lucrative rubbish, historic long views of village church spires would still exist.

I understand your Council currently does have funds, and particularly for environmental improvements, and where projects are too expensive for normal Parish Council maintenance issues, so please try to look beyond the present appearance of this neglected land that should be returned to the important contribution it used to make to the overall setting of this Conservation Area.

Perhaps also worth noting is that historically Lord Cowper had two houses on the adjoining 'oval field' former orchard, some brick footings from which still remain.

I was sorry to learn that HCC Records and Archives refused to supply A4 size historic map copies, particularly of the 1732 Griffin map, which would greatly enhance the document. I will happily lobby the Council on your behalf as we are the people who fund this resource, if required.

Yours sincerely,

cc. Parish Council

[Faint handwritten notes at bottom left]

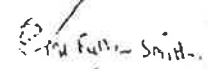

25 inches to 1 foot

③

To
East End ~~Green~~ Green

Draft Character Appraisal



East End Green
Nr. Hertford
Herts

SG14

Date 23.4.2018.

Dear Sir/Madam:

Please find enclosed Photos
taken in 1983 when we moved to East End Green
of Green & Rupp area.

First I would like to make a point about the
the Field Maple's that are planted
I don't think they enhance the green they are
covered in ivy, they were planted by Mr Gavin Paul
(tree expert to the council in approx. 1988.) The green
looked much better before when only 4 Hawthorn
were there in - before 1983 and I might add
at that time the Parish Council didn't even
cut the grass area of the Green, we the owners
of the properties took on the job for years,
until the Parish took on the job. Another point
Councils make conservation area and T.P.O.'s on
on tree ect. but do not maintain them, most are
covered in ivy which ends up killing them in
the end like 3 of the Hawthorn on the green in
front of my house. The Roads are another problem
they are not maintained often enough, gravel areas
or tarmac they are full of Potholes, the road
from Staines Green to East End Green has only
been resurfaced twice since 1983 and is in

a terrible State now.

I hope the Photo's enclosed are
of some help to you

Yours

East End Green

formerly
named

took
name with him
when he moved
to stable Block
when he split the land,
next door

he extended in
1983/84
which became

the new keepers
wood



Hawthorn
in the Dell,

I would like to see
this Hawthorn again
taken
1983

taken
1983.



Field Maple
 Planted approx
 1988
 much to close to



taken
 1983

Scribbleland at
 the east of the
 Green
 next to the Rupp.

To

Mr. M. Brown
Conservation Officer.



Development
Control

21 MAY 2016

④

Dear Mr Brown,

In Draft Appraisal
I mistook the area marked with
grey line's was to be excluded
from the Conservation Area.
I would disagree, I think it
should be kept and cleaned
up as ^{*}foot path is the entrance
to the green, over the years
it's never been touched it's covered
in weeds bramble's and fallen
tree's. If it was looked after
it is after all part of village
green, and would make a
nice entrance to the Green,
and as stated in my first
reply I would like the Dell
returned to how it was

before the Field Maple
were planted, with 4
~~has~~ Hawthorn trees as
stated in first letter
along with photo's

Yours

East End Green
nr. Hertford
Herts
5914

5. CHARACTER ANALYSIS.

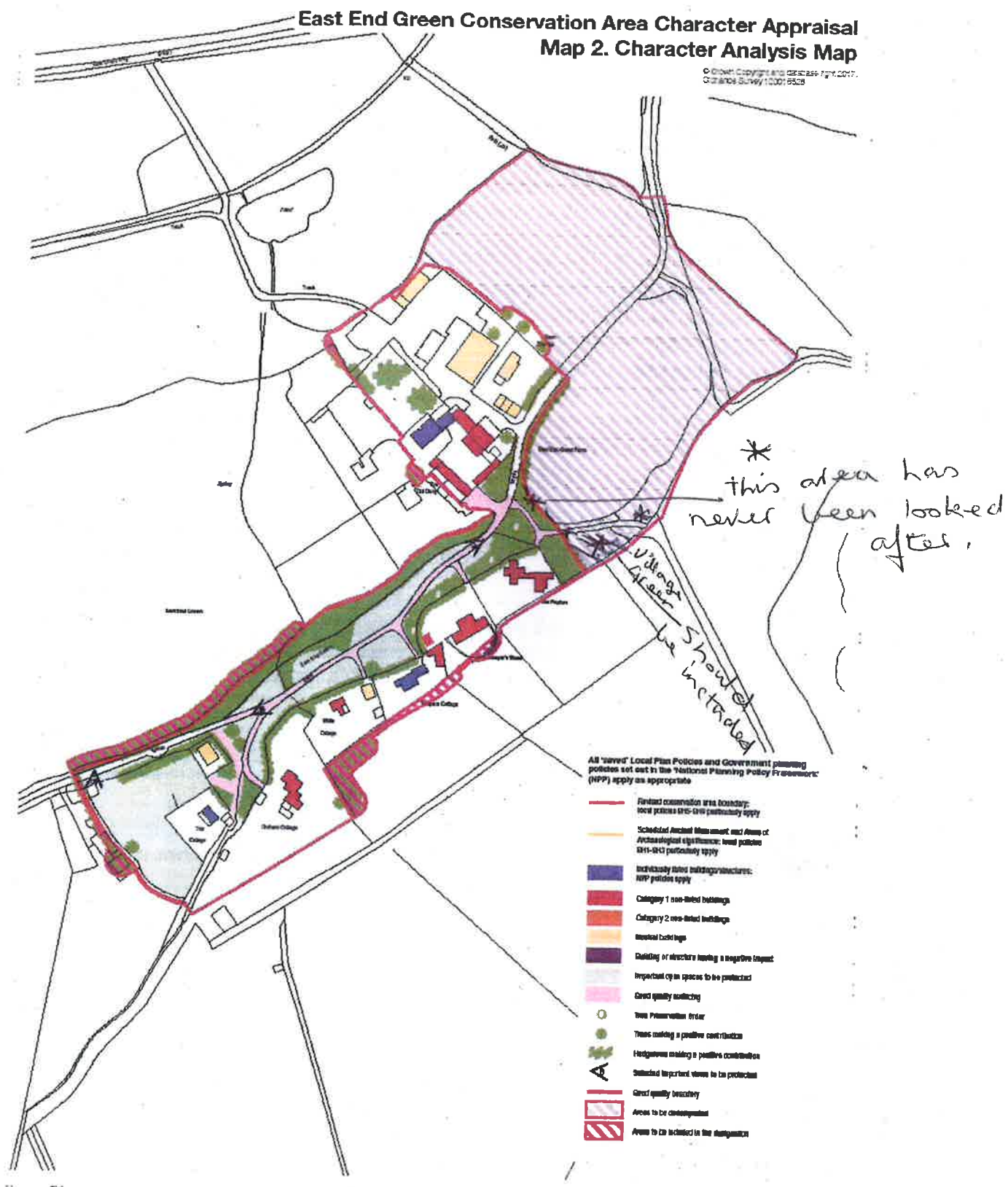

Field Maple
planted in
1986 approx



open area at
side in U-
was in 1983.



East End Green Conservation Area
Draft Character Appraisal and Management Proposals
Comment Form

Your comments are sought on the East End Green Conservation Area Draft Character Appraisal and Management Proposals. These should be made in writing and either sent or emailed to the address below by 5pm Friday 1 June 2018. Alternatively you can leave this form tonight. Any comments submitted will be publically available but will exclude personal details. If you wish to discuss the document further please contact the Conservation Team on the number below.

Name :	
Address:	East End Green, Hertford, Herts. SG14
Telephone No:	
Email:	
Comments:	Track should not be a metalled road. Tarmac would encourage speed and use as a "cut through". Surface should be of recreational standard affording pedestrians and cyclists, safe passage. Pot holes should be filled promptly to prevent injury.
Our Contact Details:	
Website: www.eastherts.gov.uk	East Herts District Council
Email: Mike.brown@eastherts.gov.uk	Wallfields, Pegs Lane
Phone: 01279 655 261	Hertford, SG13 8EQ
and ask for the Conservation Officer	